



EXTRAORDINARY LOFT OFFICES FOR SALE OR LEASE

975-10,615 square feet

GLASSWORKS is located in the heart of Midtown West on Ellsworth Industrial Boulevard with convenient access to Downtown, Midtown, Buckhead, and Atlantic Station.

Traditionally known for its industrial nature, Midtown West has become an exciting mix of eclectic buildings and well-known retailers, as well as popular restaurants and hot spots such as Bacchanalia and Taqueria del Sol.

Building A: Suites from 975-3,543 square feet

Building B: Free-standing building - 10,615 square feet

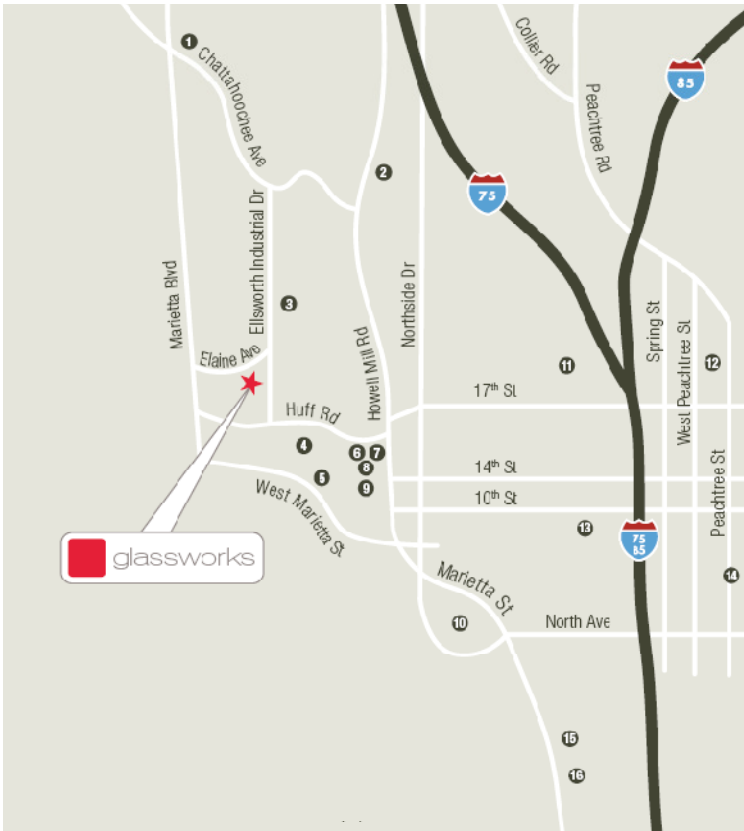

1320 Ellsworth Industrial Boulevard
Atlanta, Georgia 30318

MIDTOWN WEST

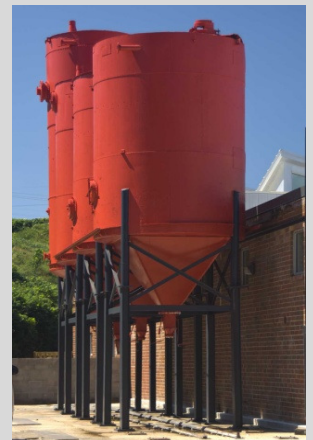

For more information please contact:

Kyle Jenks
(404) 239-9828

Jeff Pollock, CCIM
(404) 865-3877

WWW.GLASSWORKSCONDOS.COM



PARKSIDE PARTNERS

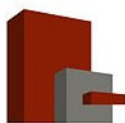

POLLOCK
COMMERCIAL



GLASSWORKS - BUILDING A

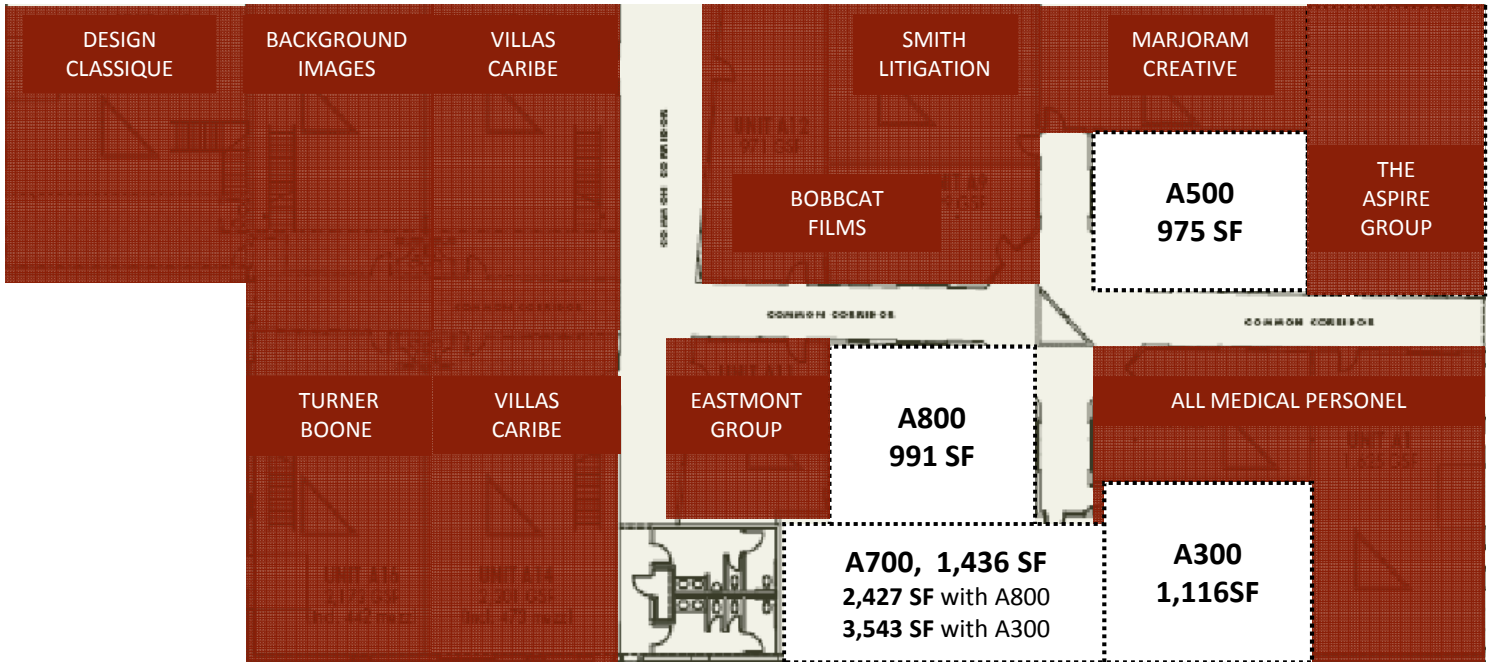

GLASSWORKS - BUILDING B

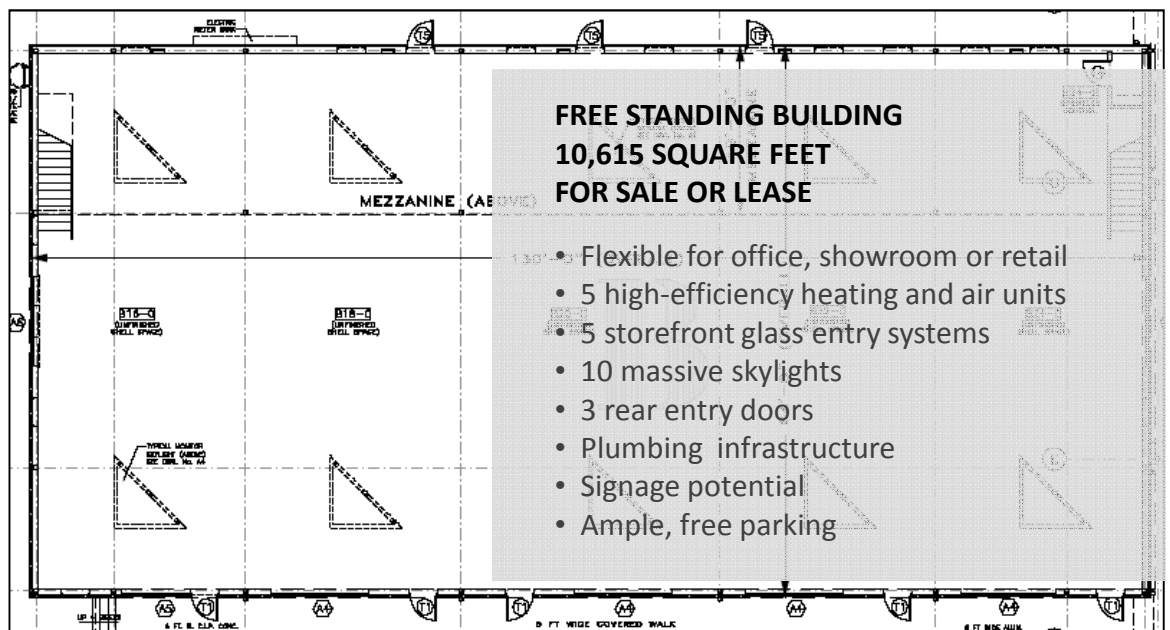

For more information please contact:

Kyle Jenks - (404) 239-9828 or Jeff Pollock, CCIM - (404) 865-3877